

BLACK SLUICE

INTERNAL DRAINAGE BOARD



Northern Works Committee Meeting

Tuesday, 13th May 2025 at 2pm

Station Road, Swineshead, Lincolnshire PE20 3PW



Black Sluice Internal Drainage Board

Station Road
Swineshead
Boston
Lincolnshire
PE20 3PW

01205 821440

www.blacksluiceidb.gov.uk

mailbox@blacksluiceidb.gov.uk

Our Ref: DW/JL/B10

Your Ref:

Date: 6th May 2025

To all Northern Works Committee Members

Dear Member

Northern Works Inspection and Meeting on 13th May 2025

Please find enclosed the papers for the Northern Works Committee Meeting to be held after the Inspection Tour of the northern area on Tuesday 13th May 2025.

We shall depart at 8:30am from the Boards Offices and arrive back for the meeting around 2:00pm. Tea/coffee and bacon rolls will be provided from 8:00am onwards, drinks and a lunch will be provided.

Please wear appropriate outdoor clothing and footwear for walking and possible trailer rides.

Yours sincerely

Chief Executive

A G E N D A

1. Recording the meeting.
2. Apologies for absence.
3. Declarations of interest.
4. To review the Northern Works Committee Terms of Reference (**pages 1 & 2**)
5. To receive and if correct sign the Minutes of the last Meeting of the Joint Works Committee held on 1st October 2024 (**pages 3 - 17**)
6. Matters arising.
7. To discuss the Operations Report and Inspection (**pages 18 - 34**)
8. To discuss the Engineer's Report (**pages 35 - 40**)
(a) Capital Schemes Budget (**pages 41 & 42**)
9. Rainfall (**pages 43 & 44**)
10. Any Other Business.

BLACK SLUICE INTERNAL DRAINAGE BOARD

NORTHERN WORKS COMMITTEE - 13 MAY 2025

AGENDA ITEM 04

TERMS OF REFERENCE - NORTHERN WORKS COMMITTEE

1. **GENERAL**

The Committee shall have ~~THIRTEEN~~ **SIXTEEN** members who will be appointed by the Board. A maximum of EIGHT Co-opted Members may also be appointed by the Committee.

The Membership shall include: The ~~SEVEN~~ **NINE** Boston Borough Council Board members and the ONE North Kesteven District Council Board member.

The Chairperson shall be elected by the committee at the triennial general meeting of the Board, being the first board meeting following an election.

Co-opted Members will be appointed by the Committee at the triennial general meeting of the Board with each Co-opted Member receiving a written invitation to join a Works Committee for a three-year term. New Co-opted Members may be approached at any time throughout the year to take up any vacancies and thereafter appointed by the Committee. It is at the Chairperson's discretion to remove Co-opted Members based on low attendance levels.

2. **MEETINGS OF THE COMMITTEE**

The Committee shall meet at least once in every 12-month period and a quorum shall be seven members.

There should be at least one inspection of each Works district each year to which all Northern Works Committee Members and Executive Committee Members should be invited.

~~No one other than the~~ Committee members, members of the public and Board Officers shall be entitled to attend Committee Meetings, but any other persons may attend meetings as a guest if invited by the Committee.

3. **POWERS OF THE COMMITTEE**

(a) Any formal consent which requires determination before the next Board Meeting which officers cannot approve.

(b) Approve any individual works or scheme up to a value of £25,000.

4. RESPONSIBILITIES OF THE COMMITTEE

The responsibilities of the Committee shall be:

1. To monitor the Board's performance in relation to effective and efficient work solutions.
2. To monitor the Board's performance in relation to good Health & Safety practices throughout daily operations.
3. To promote best practice through employee training and awareness.
4. To promote and maintain value for money for all resources.

5. REPORTING

Minutes of meetings of the Committee shall be presented to the next meeting of the Board.

The Committee shall review its terms of reference after every triennial general meeting and its own effectiveness and recommend any necessary changes to the Board.

REVIEWED BY THE COMMITTEE:

APPROVED BY THE BOARD:

BLACK SLUICE INTERNAL DRAINAGE BOARD

MINUTES

of the proceedings of a Joint Meeting of the
Northern and Southern Works Committees

held at the Offices of the Board on
1st October 2024 at 2pm

Northern Works Members

Chairperson - * Mr P Holmes

- | | |
|----------------------|--------------------|
| * Cllr P Bedford | * Mr D Casswell |
| * Cllr N Drayton | Cllr A Dorrian |
| Mr J Emerson | * Cllr A Hagues |
| * Cllr A Iazard | Mr J Fowler |
| * Mr M Leggott | * Cllr D Middleton |
| * Mr R Needham | Cllr B Pierpoint |
| * Mr J E Pocklington | Mr P Robinson |
| * Cllr C Rylott | * Cllr D Scoot |
| Cllr S Welberry | * Mr R Welberry |

Southern Works Members

Chairperson - * Mr M Rollinson

- | | |
|-----------------|-------------------|
| * Mr W Ash | Mr J F Atkinson |
| * Mr V A Barker | * Mr K C Casswell |
| * Mr J Casswell | Mr R Dorrington |
| Mr C Dring | * Cllr M Geaney |
| Cllr Z Lane | * Mr A Mair |
| * Mr M Mowbray | * Mr M Taylor |
| * Mr C Wray | |

(* Member Present)

In attendance: Mr D Withnall (Chief Executive)
Mr P Nicholson (Projects Director)
Mr S Harrison (Maintenance Director)
Mr K Methley (Pump Engineer)
Mr I Warsap (SLWP Consultant)

Mr P Holmes chaired the meeting.

2373 Recording the meeting – Agenda Item 1

Members were informed that the meeting would be recorded.

2374 Apologies for absence - Agenda Item 2

Apologies for absence were received from Mr R Dorrington, Mr J Fowler, Cllr Z Lane, Cllr A Dorrian and Mr P Robinson and Cllr S Welberry.

2375 Declarations of interest - Agenda Item 3

Mr J Casswell declared an interest in Minute 2380(jj) - Donington Northings Pumping Station Alternative Access Track - £185,430.

Mr J Pocklington declared an interest in Minute 2381 - Update on the Lincs Reservoir.

2376 Minutes of the last meeting of the Southern Works Committee - Agenda Item 4

The Minutes of the last Meeting of the Southern Works Committee held on 9th April 2024, copies of which had been circulated, were considered by the Southern Works Committee Members and it was AGREED the Minutes should be signed as a true record.

2377 Matters arising from the Southern Works Committee Meeting - Agenda Item 5

(a) Dunsby Fen Pumping Station - Minute 2298(j)

The Chief Executive explained to the committee that he has raised concerns through the Flood and Water Management Scrutiny Committee regarding the Environment Agency's (EA) plans for bank repairs at Dunsby and Quadring. Their plan is to restore the bank to the level it was previously. However, this means that during the next rainfall event which reaches the same level, the overtopping and erosion will occur again in these same places. The EA do not want to repair the bank to any higher level as they believe it would just move the problem of overtopping to the next lowest point. The Chief Executive has suggested that if the level keeps getting built up in these different locations, then it will become more resilient.

There is also the suggestion that the level of response for national assets won't be replicated in the same way it has been previously in future events. Priority is focused on urban areas and the concern that this rules out the majority of Lincolnshire has been fed back to the Flood and Water Management Scrutiny Committee. Mr K Casswell noted that if it isn't dealt with in rural areas, it won't be long before the water reaches urban areas.

Mr V Barker suggested the bank levels at Dunsby and Quadring could be increased by the Board, it was noted it isn't the Board's bank, it is EA.

Mr M Brookes noted that himself and a few others sit on the Flood and Water Management Scrutiny Committee and so can ensure it gets the required attention from the committee.

Mr M Leggott added that it is regrettable that the EA see the protection of properties as their only job, noting the amount of Grade One and Two crop production land in Lincolnshire that is holding no value in the eyes of the EA.

Mr C Wray questioned if protecting national infrastructure is within the protection of urban areas / property? Noting the new infrastructure at Bicker Fen. It was explained that anything built after 2012 (both domestic and commercial) is not classed as 'at risk' because it should have flood resilience measures within the build design.

Mr C Wray questioned if those companies with infrastructure would perhaps be willing to contribute to the raising of the bank? The Chief Executive noted that he didn't think the EA would allow it, although noting that a Quarry has been given the go ahead to complete repairs in Tumbly. Mr M Rollinson added that Bicker Fen, where the infrastructure is, is a known low spot.

Mr I Warsap suggested that bank levels are surveyed, and data provided to the EA and then be re-surveyed once the EA has completed the work. It was confirmed that the initial levels have already been surveyed.

2378 Minutes of the last meeting of the Northern Works Committee - Agenda Item 6

The Minutes of the last Meeting of the Northern Works Committee held on 2nd July 2024, copies of which had been circulated, were considered by the Southern Works Committee Members and it was AGREED the Minutes should be signed as a true record, with the following amendment:

- Minute 2345 – References site visit to Dowsby Pumping Station, this should be Damford Pumping Station.

2379 Matters arising from the Northern Works Committee Meeting - Agenda Item 7

(a) 9 metre byelaw - Residential development works – Minute 2344(a)

The Chief Executive noted that this matter was discussed further with the Executive Committee, who's suggestion was to write to local conveyancers about the 9-metre byelaw in the hope that the message will become part of the discussion when purchasing the house.

2380 To receive a report on Engineering Works for 2024 - Agenda Item 8

Maintenance

The Maintenance Director gave the following updates.

(a) Annual Summer Flail Mowing / Cutting

Summer flailing commenced on 1st August, with early season flailing completed on major pump drains following Storm Henk and Babet on a four weekly basis.

From 1st September, the programme has changed as the JCB 145 LR has been removed from the cutting programme to complete major slip repairs funded through the IDB Recovery Fund. Further slips identified whilst carrying out maintenance will be repaired by the machine near site at the time. The oldest Twiga (2015) that was due to be sold has been kept to help keep up with the flailing programme. The new Hooby machine is also carrying out cutting work and a hired excavator and driver are also currently out on site (with the option for a second hired excavator if required).

Mr V Barker questioned the fuel type of the hired excavator and whether it would be beneficial to not exchange in the next one due for replacement and instead keep as a spare? It was confirmed that the hired excavators must use white diesel.

The order for the SKDC Hand Roding contract has been received only last week. The Board were hoping to set up a Public Sector Cooperation Agreement but it is currently still being reviewed by SKDC's legal team and so it will be carried out on a contract basis.

The Maintenance Director drew attention to the maps showing completed cutting and flailing works. It was asked if more differential colours could be used going forward.

(b) Prior Notice Given for Summer Cutting

It was noted that the programme has worked well in relation to crops this year. The Chairperson questioned whether, as landowners, the members are happy with how the process works? E.g. notification of coming through crops etc.

Mr R Needham noted a circumstance where he felt that his neighbour's wheat was ran on unnecessarily as it was harvested only a week later, and the adjacent field was left until a few weeks later. The adjacent side was also clear. The Maintenance Director confirmed that if the crop is wheat, the Board would usually wait until the wheat has been cleared and so will look into this.

Mr M Rollinson also referred to alternate bank cutting and that this hasn't been happening. Mr J Pocklington agreed. Mr M Leggott suggested that this may have led to some of the 9metre byelaw infringements if people think access is only required on the one side. Mr M Taylor added of a circumstance where he asked the workforce to cut the alternate side.

The Chief Executive noted that it is Board policy to alternate bank cutting where possible and so will discuss with the Operations Team about empowering the machine operators to make the decision about which side to cut.

It was also further noted from Mr J Pocklington, and others, that there had been no notification, phone calls or texts, to inform of the Board coming on land for cutting.

(c) Summer Crop Loss / Damage Compensation

This was referenced and discussed within the above.

(d) Proposed Desilting, Bushing and Cleansing Works

These works have been put on hold due to the additional slip repair programme because of the IDB Recovery Funding achieved. A small budget has remained at the end of the financial year for if all slips are completed or all the IDB Recovery Funding has been spent. If these works are carried out, it will be the continuation of the 2023/24 season works as only 8.2km of a proposed 37km were completed due to disruptions caused by Storm Henk and Storm Babet.

(e) Bank Slips

£705,000 was achieved through the IDB Recovery Fund for major slip repair work. Currently, 16 of the original 51 identified slips have been repaired. However, more have been identified since, whilst completing maintenance work. To date, £240,000 has been spent (on budget for the original 51 identified).

Mr V Barker noted that the Board has got to consider why we are experiencing so many slips, acknowledging the amount of rainfall, but questioning if the batter of the bank is at the correct angle for the type of soil?

The Projects Director acknowledged Mr V Barker's point, noting that some slips have been known about for years but the land has been saturated and water levels high. As the land starts to dry out, it encourages the bank to slip. The Board have also recently reviewed water levels and increased where possible, which can also have an impact. The Projects Director also noted the amount of work that would be involved in doing a design profile for each one and that a bigger gradient would require more land take and therefore increase cost.

Mr M Rollinson questioned the process if the Board encounters a slip whilst completing Public Sector Cooperation Agreement (PSCA) work on EA banks? It was confirmed that it is reported to the EA and then they make a decision as to whether they want the Board to carry out the repair on their behalf or if they put it out to framework. The Board have completed works previously.

Projects

The Projects Director gave the following updates.

Capital Asset Improvements – 2024/25 Flood and Coastal Erosion Risk Management Grant in Aid (FCERM GiA) Schemes

(f) North Forty Foot cleansing / revetment & Langrick Road pipeline, lining / replacement works

There were no further comments or questions about this work.

(g) Sempringham Fen Pumping Station refurbishment

Most of this refurbishment is now complete. Further contingency funding can be claimed (£25,000) which will enable some of the gravity outfall works, which is currently being looked into.

(h) Allan House Pumping Station outfall repair

The contractors are currently on-site (ASDA carpark) installing inspection chambers to enable access into the pipe to complete a camera survey to establish the condition of the pipe.

The issue with the last 12m section which outfalls into the Haven (displacement in one of the joints in the pipes) is to be completed in conjunction with these works. The first, newer, section is plastic, the older is cast iron. It is also not known exactly where the pipe is.

There is also work to the existing Pumping Station building including raising the control panel and raising the height of the building to accommodate this (within existing footprint).

(i) Black Sluice Catchment Study

Data is still being gathered for this study, there is currently a survey team of 6 out on site, employed by the subcontractor, in order to do the next stage of modelling and looking at whether decreasing to 12 pump catchments from 34 is feasible.

(j) South Forty Foot Upper Catchment Natural Flood Management (NFM)

The lead on these NFM works has been Lesley Sharpe, who has now retired, and because of this, this work has come to its natural fruition. The works that are already ongoing will be completed, but nothing further will be commenced.

(k) Bicker Fen Catchment Works

There were no further comments or questions about this work.

(l) Dunsby Fen Catchment Works

There were no further comments or questions about this work.

(m) Wyberton Marsh Pumping Station New Transformer

Funding for this work has been approved and received (£130,000 + £37,000 contingency if required). Discussion is currently ongoing with National Grid to remove the transformer and provide an LV connection to this site and get the work completed this financial year.

(n) Ewerby Fen Catchment Works

There were no further comments or questions about this work.

(o) Embankment repairs at Trinity College, Damford, Ewerby and South Kyme

The committee were reminded about the issues experienced at the four Pumping Stations named above in relation to the water running around the stations, through or over the bank, during high water levels. This has been ongoing for five years, funding has tried to be achieved through Grant in Aid and IDB Recovery Funding, the outcome of the IDB Recovery Funding Tranche 2 is not yet known.

Discussion has commenced with a contractor, Balfour Beatty, to deliver this work and they have provided a 33-week programme of work, which they could commence in May 2025.

The initial estimation was £3.8million, which following further work and detail, has now increased to a revised estimation of £7.495million. Stantec have been asked to produce a tender pack to go out to be able to understand if the quote provided by Balfour Beatty is competitive. The project will then be in a better place to commence when funding is achieved.

Committee members noted the large increase from initial estimation to the revised cost? It was noted that the initial estimation did not include for any temporary work such as platforms, access roads, etc.

Mr R Needham questioned how much was applied for in the IDB Recovery Tranche 2 Funding? It was noted that the original estimated cost of £3.8million was bid for, however, the Board have been given an indication that it won't be successful due to it being unlikely the works could be completed prior to the end of the financial year.

2024/25 BSIDB Funded Capital Schemes

(p) **Major Slip Repairs**

There were no further comments or questions about this work.

(q) **Jetting to Major Pipelines – Estimate £75,000**

There were no further comments or questions about this work.

(r) **General Culvert replacement contributions - £5,000**

There were no further comments or questions about this work.

2024 DEFRA Funded Scheme

(s) **Peat Restoration Project – LAPSIP (Lowland Agricultural Peat Small Infrastructure Pilot) - £172,000**

The Board has secured funding (£172,000) to install tilting weirs at two sites in Bourne to hold water at a higher level. This is programmed to be completed in November. The titling weirs will be solar powered and operated remotely.

Pumping Station Schemes

(t) **Great Hale Fen Pumping Station Pump Drive Couplings – Estimate £30,000**

There were no further comments or questions about this work.

(u) **Kirton Marsh Pumping Station Under Pump Inspections – Estimate £11,000**

There were no further comments or questions about this work.

(v) Rippingale Fen Pumping Station Under Pump Inspections – Estimate £25,000

There were no further comments or questions about this work.

(w) Hacsonby Fen Pumping Station Under Pump Inspections – Estimate £25,000

There were no further comments or questions about this work.

(x) Donington Wykes Pumping Station MCC – Estimate £30,000

The control panel in this pumping station was installed in 1988 and there have been issues with the operation of this panel recently.

(y) Pumping Station various water level controllers – Estimate £30,000

This project is to eliminate the issue of existing water level readers being submerged under water during high water levels.

(z) Damford Grounds Pumping Station Refurbishment 2 x axial flow pumps and motors - £50,000

One of the pumps and motors has been refurbished with the other to be completed when those identified within Tranche 1 are completed which take priority.

(aa)Damford Grounds PS Replace MCC - £60,000

This is now completed, and a funding bid has been submitted within Tranche 2 of the IDB Recovery Fund to retrospectively fund this, if successful.

(bb)Donington Wykes PS Replace MCC - £30,000

There were no further comments or questions about this work.

2024/25 IDB Fund Tranche 1

The committee were reminded of the Tranche 1 IDB Recovery Fund (£75million available) of which everything the Board applied for was achieved. This funding must be spent by the end of the financial year – 31 March 2025. The electricity funds (£452,936) has all been received and the initial payment for the bank slip repair funding (£705,220). Although the funding for the pumping stations has been approved (as detailed in the below), the funding has not actually been received. It is now being queried about whether a 'refurbishment' meets current regulations. For example, the Board would normally remove the pump, have it serviced / replaced serviceable parts and put it back. However, it is now being questioned whether they should be replaced with fish and eel friendly pumps. The cost of fish and eel friendly pumps are a lot more expensive / unaffordable. The Board has placed orders and commenced this work as if it is not started, it will not be completed by the deadline. Ian Cappitt (Partnerships & Strategic Overview Senior Team Leader, Lincolnshire and Northamptonshire, Environment Agency) has taken the lead on talking to the Environment Agency national fish and eel team about this matter.

Cllr A Iazard questioned if there would be a possibility of an extension of the 31 March 2025 deadline? It was noted that ADA are lobbying for an extension of the deadline, especially in relation to Tranche 2 of the funding as the decisions on the success of the bids have not even been made yet.

The notification of the outcome won't be shared with the Board until two weeks after the budget due to the funding still being with Treasury and it not being known if it will still be available after the budget. Mr K Casswell noted that he doesn't believe Tranche 2 of the funding will be available.

The committee expressed their gratitude for the work of the Board's Officers in achieving this funding.

(cc) Helpringham Fen Pumping Station Refurbishment - £219,709

The pump is being lifted out today at Helpringham Fen Pumping Station.

(dd) South Kyme Fen Pumping Station Refurbishment - £289,709

There were no further comments or questions about this work.

(ee) Dunsby Fen Pumping Station Refurbishment - £144,709

There were no further comments or questions about this work.

(ff) Ewerby Fen Pumping Station Refurbishment - £359,709

There were no further comments or questions about this work.

(gg) Pinchbeck North Fen Pumping Station Refurbishment - £195,000

There were no further comments or questions about this work.

(hh) Dyke Fen Pumping Station Automatic Weedscreen Cleaner Refurb - £30,000

There were no further comments or questions about this work.

(ii) Donington Northorpe Culvert Repairs - £155,000

It was explained that a concerned property owner contacted the Board about their driveway collapsing where it is over a piped section of Board watercourse. The pipe has been CCTV surveyed and has found that the old steel Armco has started to deteriorate and collapse. This has been repaired and we are now considering lining the remaining length of pipe not repaired, using the remaining funding.

(jj) Donington Northings Pumping Station Alternative Access Track - £185,430

Mr J Casswell declared an interest.

The committee were reminded that the current access to Donington Northings Pumping Station is across a railway line, correspondence with National Rail has been ongoing for ten years about an alternative and due to the headwall of the culvert leading up to the crossing collapsing during the winter storms, it was decided to bid within the IDB Recovery Fund for funding for an alternative access track, which has been successful. The alternative route has been plotted and plan prepared to send out for approval.

It was noted that the culvert adjacent to the railway that is used for vehicular access has collapsed and so there is currently no vehicular access to the pumping station.

Mr C Wray suggested that if the Board keep using it and crossing the railway then National Rail would have to pay the Board to stop using it, noting the bigger nuisance the Board are by using it, the quicker it would be resolved with them. Board's Officer's noted this, but also acknowledged that funding has been achieved from elsewhere to complete the work for an alternative route.

2024/25 IDB Fund Tranche 2

(kk) Horbling Town Beck Penstock installation - £225,000

There were no further comments or questions about this work.

(ll) Mobile Pumps - £235,000

The committee were informed that the Executive Committee have agreed to the purchase of an 8" mobile pump, ahead of knowing if the bid for funding for it has been successful. This is so that the work at both Helpringham and Pinchbeck Pumping Stations can be carried out simultaneously. Board's Officers are visiting the preferred supplier this week to view the proposed pump.

It was noted that the Board's current 8" mobile pump is well used and is currently on site at Helpringham.

(mm) Damford Grounds Pumping Station Refurbishment - £90,000

There were no further comments or questions about this work.

(nn) Great Hale Pumping Station Refurbishment - £30,000

There were no further comments or questions about this work.

(oo) Installation of Level Controllers at Various Pumping Stations - £30,000

There were no further comments or questions about this work.

2024/25 Defra / EA FCERM GiA Schemes

- (pp) Natural Flood Management (NFM) Studies - £150,000

There were no further comments or questions about this work.

- (qq) Wyberton Marsh Pumping Station New Transformer - Estimate £50,000

There were no further comments or questions about this work.

2025/26 Board Funded Capital Schemes

- (rr) SFFD Desilting Guthrum to Black Hole Drove PS – Estimate £105,000

The Projects Director noted that he would like to complete this work and will review how much silt there is to be removed and the most appropriate mechanism of doing so which will likely be a hired long reach excavator, placing material into a cradge with bucket and cradge.

- (ss) Jetting to Major Pipelines – Estimate £40,000

There were no further comments or questions about this work.

- (tt) Black Hole Drove PS Under Pump Inspections - £35,000

There were no further comments or questions about this work.

- (uu) North Forty Foot Desilting - £20,000

There were no further comments or questions about this work.

- (vv) General culvert replacement contributions - £5,000

There were no further comments or questions about this work.

2025/26 Pumping Station Schemes

- (ww) Dunsby Fen PS replace automatic weedscreen cleaner – Estimate £140,000

This weedscreen cleaner was installed in 2000 and so is due for replacement.

- (xx) Gosberton Fen PS replace MCC – Estimate £80,000

This Motor Control Centre(MCC) was installed in 1996 and is now due for replacement.

- (yy) Wyberton Marsh PS replace MCC – Estimate £80,000

This Motor Control Centre(MCC) was installed in 2000 and is now due for replacement.

Pumping Station Maintenance, External Recoverable Works, Health & Safety and External Partnerships, Strategies & Agreements were noted as per the report within the agenda, with no further comments or questions.

2381 Update on the Lincolnshire Reservoir (SLR) - Agenda Item 9

The SLWP Consultant gave an update as follows:

Scheme overview – The Lincolnshire Reservoir is a project in conjunction with a second reservoir (Fens Reservoir), £30million has been spent on the two projects so far and is a £2.48billion scheme.

The Lincolnshire Reservoir has currently been delayed by two years, but it is hoped, from the learning of the Fens Reservoir, that the pre-construction phase can be condensed with commencement on site for the Lincolnshire Reservoir being 2031/32. It was noted that Anglian Water are paying for the Board's Officers time spent on developing this project. The Lincs Reservoir will have a volume of 50 million cubic metres, with a 10% additional margin if required and 500ha footprint.

Downstream Transfer - The downstream transfer will be from the Lincs Reservoir to Wilsthorpe to Chesterton.

Upstream Transfer - There will be an upstream transfer from the Trent into the Foss Dyke (hybrid transfer, both pipeline and open channel) with pumping station to pump into Foss Dyke. The water will then continue through Lincoln into the River Witham and from the River Witham to a point of abstraction into the South Forty Foot Drain (SFFD).

There are two options in relation to the transfer from the River Witham to the SFFD; an open water transfer from the Chapel Hill area or piped from the Antons Gowt area. The pipeline would have one pumping station and the open transfer could have one or two pumping stations. The SLWP Consultant noted that he believes the Anglian Water team are overcomplicating the transfer, adding the potential use of gravitation flows between the River Witham and SFFD, there being a 1.5metre fall between the River Witham (Langrick Bridge) and SFFD (Swineshead Pumping Station).

The abstraction at the River Witham into the SFFD will be a maximum of 400 mega litres per day, all of which will be transferred into the Lincs Reservoir. The transfer from the River Witham to the reservoir will take one hour.

There is a proposed new lock on the Kyme Eau (east side) to protect water into the River Witham.

For an open water transfer along the Kyme Eau into the Holland Dyke, the drains would be widened, and so additional land take would be required. Conversion of Holland Dyke to enable gravitation into the Skerth will require land take, level changes and replacement or relocation of the South Kyme Pumping Station.

The SLWP Consultant next explained the increase in water levels (normal flow) for the different options:

- Location at Northing Ings Railway Bridge:
 - Piped: 50mm increase
 - Open water transfer: 40mm increase
- Location at Hubberts Bridge:
 - Piped: 140mm increase
 - Open water transfer: 90mm increase

When the SFFD is in an event situation, water would be taken out for the reservoir (minimal velocity flows).

A short pipe would be required between the River Witham and Kyme Eau with a Pumping Station with open channel transfer along the Kyme Eau, with a pipe transfer between the Kyme Eau and Holland Dyke to reduce the transfer of Invasive Non-native Species (INNS) between catchments.

However, the SLWP Officer noted that there is already a connection point at the Black Sluice Complex and is also nothing to stop INNS travelling across catchments via land or air.

Emergency Drawdown – This will include the upgrading of existing assets including the SFFD and Helpringham South Beck (widening).

Mr K Casswell referenced the point that water will be taken in an event and the concern that the reservoir would be full and so couldn't take any more? The SLWP Consultant noted that there is 10% additional capacity (5million cubic metres). Holding water in the River Witham will be controlled by Grand Sluice Doors.

There is currently an integrated water management study ongoing, involving organisations including the Environment Agency, IDB, Anglian Water, Canal & River Trust, looking at how this network would be controlled.

The SLWP Consultant highlighted the importance of having one organisation controlling it, and the potential benefit for if the Board controlled it and were funded to do so.

The SLWP Consultant noted that it is currently being argued that the reservoir doesn't offer any increased flood resilience, however the SLWP Consultant disagrees with this, noting the upgrade to main-river banks and ongoing maintenance.

Mr R Needham noted the insignificant drawdown, the SLWP Consultant noted that if the water is available from the SFFD it will come from their firstly, noting the cost involved in pumping between the River Witham and SFFD and between the River Trent and Foss Dyke, which would not be required if coming straight from the SFFD.

Mr V Barker noted the River Trent water being saline, with the SLWP Consultant noting that all the appropriate water testing has been done.

Mr R Welberry questioned if there would be a lock on the SFFD at the Skerth? The SLWP Consultant noted that it will be the renewed lock.

The SLWP Consultant further noted that Matt Pluke (Anglian Water), Adam Robinson (Anglian Water) and Darren Smith (EA SLWP Officer) would be willing to come and give a presentation about it at the November Board meeting if wanted. It was noted that it would have been helpful to have visuals on the screen to be able to visualise what the SLWP Consultant has explained.

The SLWP Consultant also noted the recent letter received from Anglian Water, detailing updates and programme schedule for the Lincs Reservoir, suggesting it be put on the Board's website.

The Chief Executive noted that the letter was sent to the Board as a landowner, so suggested it shouldn't be posted on the website, but will circulate following the meeting.

The SLWP Consultant noted that feedback from the public is suggesting that the majority are in favour of the reservoir going ahead.

The next big decision to be made is whether it is an open or piped transfer from the River Witham to SFFD, the capital and maintenance cost of the open transfer are higher, but it also has more significant carbon benefits.

The SLWP Consultant also noted that by the time Lincs Reservoir is in operation (2039), four more will be required in the area.

Mr C Wray noted that he doesn't believe the homeowners are getting on well with Anglian Water due to them giving valuations for property that is below market value.

Mr V Barker questioned where the widening of the SFFD would begin and finish? The SLWP Consultant noted that it would likely be more a case of doing similar to the Boston to Peterborough Wetland Corridor and adding in bends etc. rather than being straight, for extra capacity.

The SLWP Consultant also noted that there has been some different interpretation of the Reservoirs Act and the criteria for discharging is now less than initially thought and so water levels will not require to be any higher than the current banks.

Mr M Rollinson questioned if anything further had developed in relation to the Black Sluice Pumping Station (Boston) through this project? It was noted that the Environment Agency aren't interested.

Mr J Pocklington questioned whether desilting of the SFFD would be carried out through this project? The SLWP Consultant noted that Anglian Water will need to maintain continual efficient flows to the reservoir through regular maintenance.

The committee thanked the SLWP Consultant for his update.

The SLWP Consultant questioned the Board's favour on whether the transfer from the River Witham to SFFD is open water transfer or piped? The Chief Executive noted that the Board supports the open water transfer for the additional benefits it brings, but ultimately it doesn't really matter to the Board how the water arrives at the SFFD. The most relevant aspect for the Board is the SFFD and potential changes to it.

It was noted that this viewpoint was outlined in the Board's response to the Phase 2 consultation, which was circulated to Board Members, and will be circulated to co-opted members following the meeting.

Mr J Pocklington, declaring an interest as an affected landowner, noted that both options would affect him but that he would prefer the piped option.

2382 Report on Rainfall - Agenda Item 10

The rainfall figures at Swineshead and Black Hole Drove were circulated. The Committee RESOLVED that this report be noted.

2383 Any Other Business - Agenda Item 11

(a) Visit from Richard Tice MP - 12 October 2024

Cllr D Middleton noted that it has been organised for Richard Tice to sail on the Boston Belle to look at the Boston Barrier on Saturday 12th October 2024 at 11am, extending an invitation for a couple of representatives of the Board. Board's Officer's noted that they will discuss and correspond accordingly.

(b) Board Plant – Bulldozer

Mr V Barker suggested that the Board should have their own bulldozer, as opposed to hiring one, noting that he feels it is a huge waste of money and was not satisfied with what he witnessed in relation to how much and how it was used.

It was noted that it is hired in to spread after desilting, adding that the Board did consider purchasing a Drott but couldn't find one that was value for money and so it is hired in on a day rate to complete that job.

(c) Sub-committee Membership

The Chairperson noted that the new Board will sit for the first time in November and that, due to this election, sub-committee membership is currently being reviewed. The Chairperson therefore invited any appointed members to make it known if they would have an interest in joining any of the sub-committees (Audit & Risk, Environment, Structures).

There being no other business the meeting closed at 16:10.

BLACK SLUICE INTERNAL DRAINAGE BOARD











Slip Repair at Bicker Fen

NORTHERN WORKS COMMITTEE INSPECTION Tuesday 13th May 2025

**Northern Works Committee Inspection Route
May 13th 2025**



Legend

-  Sites
-  Points of Interest
-  Inspection Route
-  Pumping Stations
-  BSIDB Maintained Piped Drains
-  BSIDB Maintained Open Drains
-  Main Rivers
-  BSIDB - Boundary

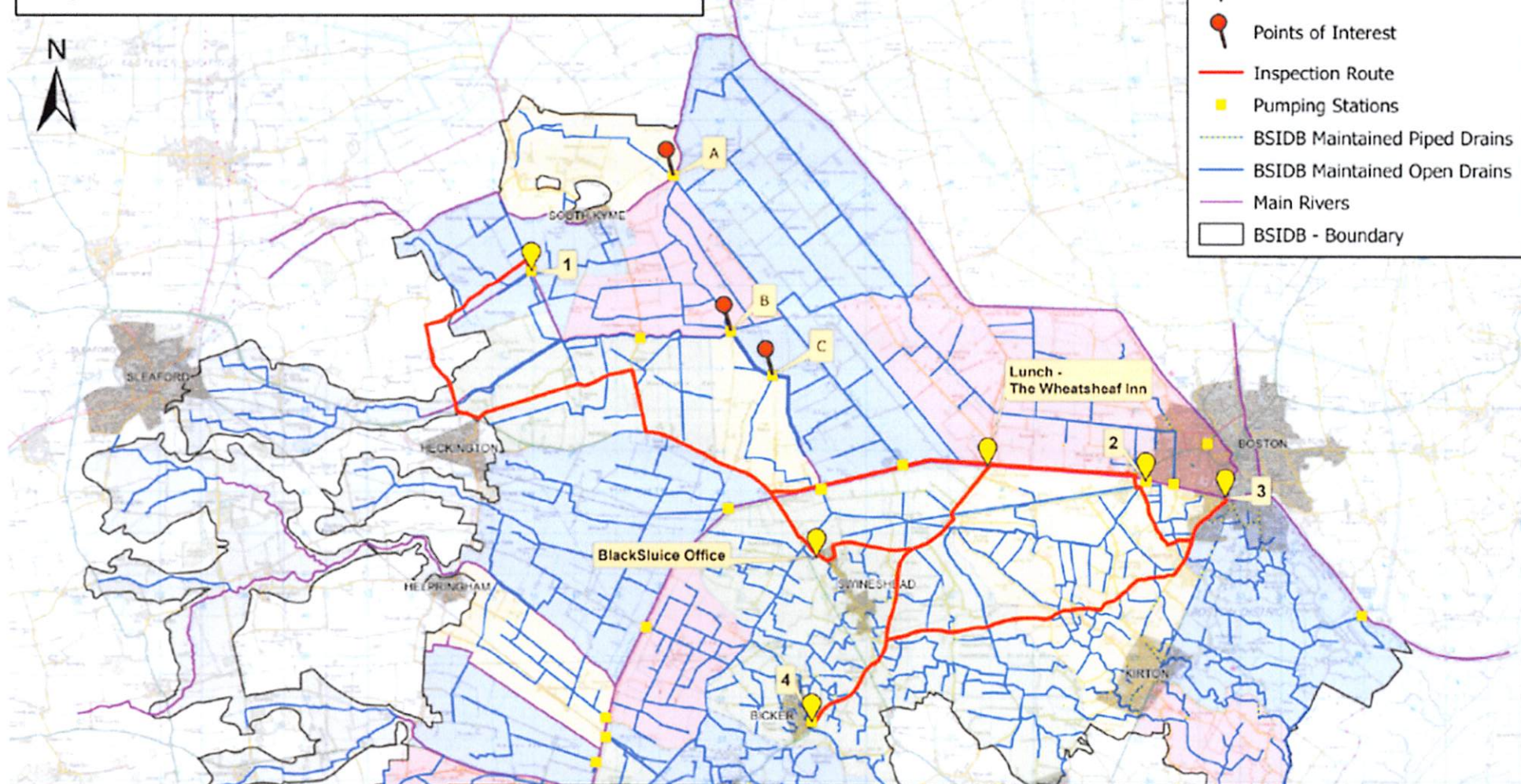

Black Sluice Internal Drainage Board
 Station Road, Swineshead,
 Boston, Lincolnshire PE20 3PW
 Tel: 01205 821440
 Email: mailbox@blacksluiceidb.gov.uk

Northern Works Committee Inspection Route

© Crown Copyright and database right 2025. All rights reserved. Ordnance Survey Licence number 100021578	Date: 06/05/2025
	Scale: 1:130,000

NORTHERN WORKS COMMITTEE
INSPECTION ITINERARY
TUESDAY 13 MAY 2025

BSIDB Offices

1 Ewerby Fen Pumping
Station

2 Chain Bridge Pumping Tea Break
Station

3 Black Sluice Pumping
Station (Boston)

4 Bicker Eau Review Planning application

5 Lunch The Wheatsheaf, Hubberts Bridge

BSIDB Offices

Northern Works Committee Meeting

1. Ewerby Fen Pumping Station - exceedance rainfall events





As previously discussed at the 2024 Northern Works Committee meeting, ongoing issues with flows around or through Environment Agency main river raised embankments continues to be a problem at four of the Board's pumping stations at Ewerby Fen, South Kyme Fen, Trinity College and Damford Grounds.

Initially identified in 2019, during heavy rainfall events and higher water levels in main river outfalls, there are increased flow paths of water around these pumping stations.

South Kyme Fen Pumping Station was the first to show signs of water seepage around the sides of the building, which was then significantly the worst of the four. During a high water level event this station is not safe for the Board's operatives to visit due to the flow paths across the access to the site.



South Kyme Pumping Station



Ewerby Fen did not present initially as the worst, but during the high water level events of Storm Babet 2023, Storm Henk 2024 and the high rainfall event at the start of January 2025 it has progressively got worse now creating a large hole in the embankment below the existing concrete retaining wall.





Stantec consultants were commissioned to develop a specification for two tender packs due to the type of works required.

Damford Pumping Station as a single site tender, Trinity College, South Kyme Fen and Ewerby Fen, the other tender.

Funding originally applied for by FCERM GiA, but also included in the IDB Fund.

Damford PS successfully received funding of £105,346.00 from the application made to the IDB Fund in Tranche 2B.

Further information can be found on schemes within the IDB fund in the Engineers Report

2. Chain Bridge Pumping Station refurbishment FCERM GiA £1,500,000

FCERM GiA funding, recently completed structural inspections at this site, Structural Engineer recommendations have not been provided at time of writing this report. The photos below show the extent of corrosion to steel support stanchions:



Due to the structural failure of Swineshead PS, Wyberton Chain Bridge PS along with Donington Northings PS which is in the Southern Work catchment were both identified for refurbishment.

This is because Wyberton Chain Bridge PS is connected downstream of Swineshead PS and Donington Northings PS upstream.

The refurbishment proposed as Swineshead PS will have limited use due to the structural failing.

It is therefore expected that Wyberton Chain Bridge PS will be used more and a scheme of refurbishment is required, detail of which is included within the Engineer's Report.

HV Transformer proposed to be replaced as part of the scheme:



Chain Bridge has important environmental aspects. The Board has installed an artificial snake nest at the bottom of the bank. There has been no record of snake sightings to date, however the environment officer is currently monitoring the area for snake activity and will survey for eggs in July.

A section of the bankside has previously been adapted to provide suitable kingfisher nesting habitat, however there is no current evidence of usage. Artificial piping to mimic a tunnel chamber could be installed in attempt to aid uptake of the habitat.

A breeding pair of swans continue to nest in the bankside at Chain Bridge, and we are currently exploring options for building and installing an artificial nesting platform for them. The swans are returning to the same spot each year for nesting and are therefore making it challenging to cut the section of bank in question. The proposed new artificial platform would be placed in an area that wouldn't interfere with board operations.

There are two options available: a fixed platform on posts, or a floating platform anchored with enough slack for water level change. Below is an inspiration photo of what can be built:

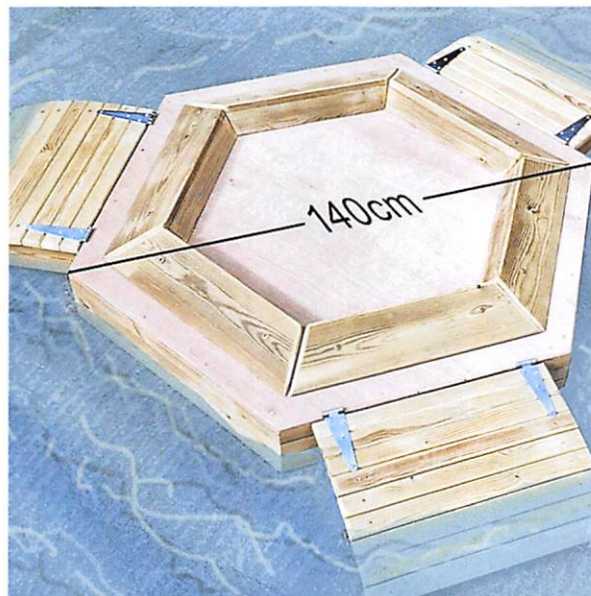

B&M Environmental Waste

A large environmental concern at Chain Bridge is the on-going litter and pollution coming from B&M, which backs onto the drain. The volume of litter leaving the yard of the store and entering the watercourse, bankside, and surrounding area is very high. As an environmentally sensitive area for breeding species, this needs to be controlled. Photos of the standard state of the area are to view below, which also showcases plastic waste directly within the artificial snake nesting site. Furthermore, plastic pollution has been used as nesting material by the swans, who are currently incubating eggs.





Information presented to the Northern Works Committee in 2018

April 2018

Large amount of litter and debris associated with the retailers in the Alban Retail Park noted.

Letters sent to Store Managers of B&M and Maplin's (as was) regarding Board-maintained watercourse and their responsibilities regarding waste management, specifically under Byelaw No. 7 which states:

No person shall, so as directly or indirectly to obstruct, impede or interfere with the flow of water in, into or out of any watercourse or so as to damage the bank:-

(a) discharge or put or cause or permit to be discharged or put or negligently or wilfully cause or permit to fall into any watercourse any object or matter of any kind whatsoever whether solid or liquid.

(b) allow any such object or matter as is referred to in sub-paragraph (a) of this Byelaw to remain in proximity to any watercourse in such manner as to render the same liable to drift or fall or be carried into any watercourse.

Stores given 14 days to clear debris. Deadline lapsed with no action taken. Board workforce carried out works to clear debris. Invoices for works sent to Head Offices of each company. Invoices paid.

January 2018

Further build up of debris noted along bank and kingfisher nesting site after period of high winds. Attempts have been made to clear grassed area around B&M site, but not bankside. Board's officers suspect retailers will cite H&S as reason for not clearing bankside.

NB: current arrangements regarding the Fly Swat works state that the Board would retrieve debris from watercourses with the Fly Swat gangs collecting from each site. This was primarily due to H&S considerations, as the Board already has SSOW and Risk Assessments in place.

Board notes current BBC "Name & Shame" campaign within Boston. Should this campaign include retailers and businesses, and not just individuals?

3. Black Sluice Pumping Station (Boston)

In 1946 the Black Sluice Pumping Station came into operation together with the widening of 11 miles of the South Forty Foot Drain from Boston to Donington Bridge. The Black Sluice Pumping Station was equipped with 3 Ruston vertical five cylinder 900 horse power diesel engines driving 100" diameter vertical spindle pumps.

An extraordinary high tide occurred on the 31st January 1953 which caused widespread damage and loss of life in areas north of Skegness and on the Norfolk coast. A tidal surge of approximately 8 feet in height was created on the Lincolnshire Coast by low barometric pressure in the North Sea and a north east wind, Force 9-10. The tide in the River Witham rose to + 17.40 ft O.D. Newlyn.

The only damage to the Black Sluice area was overtopping of private sea banks on Battery Farm, near Boston, and Bradley's Farm on Wyberton Marsh, flooding approximately 120 acres.

Between 1950 and 1958 the Board constructed six electrically driven land drainage Pumping Stations and one diesel Pumping Station to improve the drainage of approximately 11,000 acres of low lying land. The remaining land depended on very old pumps and gravity drainage to Black Sluice.

The Black Sluice outfall pumps had operated for ten years to relieve the flood levels in the South Forty Foot Drain and tributaries but the resulting water levels were not sufficient to drain the land to the standards required by modern agriculture.

Therefore at their meeting on 21 st December 1960 the Board adopted a scheme estimated to cost £1.4 million for the provision of interior pumps in the Black Sluice area with a view to bringing the drainage of the area up to modern agricultural requirements by controlling water levels to 3 feet below the lowest land level under run-off conditions of 20 cusecs per 1,000 acres. The scheme involved the pumping of an additional 70,000 acres of land into the South Forty Foot Drain, together with the replacement of existing pumps. The Lincolnshire River Board was approached and agreed to install an additional two 100" pumps at the Black Sluice Pumping Station and improve 7 miles of the South Forty Foot Drain from Donington Bridge to Rippingale Running Dyke to deal with the additional discharge. It was also agreed that the Lincolnshire River Board would take over from the Black Sluice Board and raise the banks on 41 miles of highland drains, in anticipation of higher flood levels.

This work was carried out between 1962 and 1968 and proved itself when higher flood flows in 1968/69 were dealt with within a margin of safety.

Pumps discharge 60 cumecs (60,000 litres) per second (for all 5 working) – navigation lock and sluice discharge up to 120 cumecs

South Forty Foot Drain is 32km from Black Hole Drove PS to Black Sluice PS



4. Bicker Eau

The Board have received a planning application to develop this area of land as per the proposed plans shown. The application is for the construction of 2 new residential properties. As can be shown on the application to the North of the site there is a Board maintained piped section of watercourse which the applicant has proposed a relaxation of the 9m byelaw distance to 4.5m to enable the development of the site.

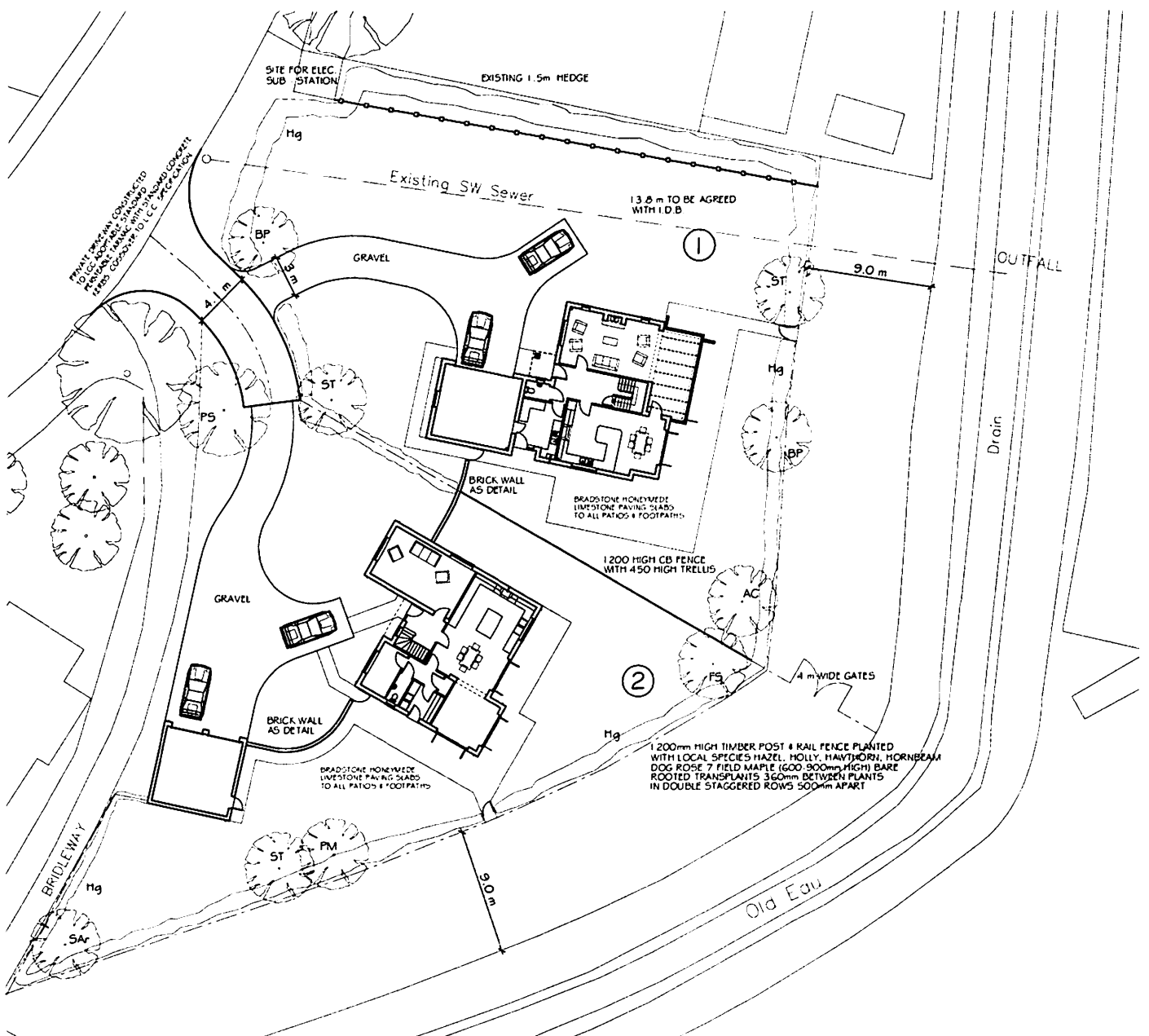

Slips Completed 2024/25

Map	Drain Number	Drain Location	Meterage	Construction Method	Costs
Original Identified Slips In The Northern Work Area					
	12/7	Punchbowl Lane Boston	22m	Post And Board +Kidds	£4,152.00
	12/2	Punchbowl Lane Boston	15m	Piles and Backboards	£6,736.80
	12/7	Punchbowl Lane Boston	15m	Post And Board +Kidds	£4,702.50
	12/2	Punchbowl Lane Boston	30m	Post And Board +Kidds	£9,405.00
	4/2	hamond beck	120m	Gabions	£162,000.00
	4/2	Hammond Beck	20m	Post And Board +Kidds	£6,226.00
	4/2	Hammond Beck	20m	Post And Board +Kidds	£6,226.00
		hamond beck low ground	20m	Closepile	£21,000.00
	4/2	Hammond Beck	20m	Post And Board +Kidds	£6,226.00
	4/2	Hammond Beck	30m	Post And Board +Kidds	£9,339.00
	9/10	Branch west Sadless lane Heckington	15m	Post And Board +Kidds	£2,983.20
	9/10	Branch west Sadless lane Heckington	25m	Post And Board +Kidds	£7,782.50
	11/12	North Forty Foot Drain	20m	Closepile	£21,000.00
	11/12	North Forty Foot Drain	30m	Closepile	£25,000.00
	11/12	North Forty Foot Drain	30m	Post And Board +Kidds	£9,339.00
	11/12	North Forty Foot Drain	30m	Post And Board +Kidds	£9,339.00
	11/12	North Forty Foot Drain	25m	Closepile	£23,000.00
	11/12	North Forty Foot Drain	30m	Post And Board +Kidds	£9,339.00
	11/12	North Forty Foot Drain	30m	Post And Board +Kidds	£9,339.00
	3/1	Bicker Drove Pump Station	85m	Piles and Backboards	£22,440.00
	10/2	Great Hale Eau Pump Drain	255m	Post And Board +Kidds	£72,165.00
		fen houses	5m	Post And Board +Kidds	£3,322.00
	6/7	Frampton Town Drain	20m	Post And Board +Kidds	£6,226.00
	4/44	Packhorse Lane Swinshead	25m	Post And Board +Kidds	£7,782.50
Additional Slip Completed In The Northern Work Area					
	4/46	Low Grounds		Post & boards	£40,350.00
	4/3	Low Grounds		close piles	£21,000.00
	4/44	Swinshead Depot		Post & boards	£3,223.00
	5/49	Four Cross Roads		close piles	£21,000.00
	12/1	Boston West		Post & boards	£16,615.00
	5/2	Kirton Holme		Piles/Booards	£23,345.00
	5/14	Rolec-Drain		Piles/Booards	£9,338.00
	9/2	600's		Post & boards	£9,969.00
					£609,910.50

BLACK SLUICE INTERNAL DRAINAGE BOARD
NORTHERN WORKS COMMITTEE - 13th May 2025
AGENDA ITEM 08
ENGINEER'S REPORT

Capital Asset improvements

1. 2025/26 Defra/EA Funded Flood and Coastal Erosion Risk Management (FCERM) Grant in Aid (GiA) Schemes

- (i) Wyberton Chain Bridge PS Refurbishment – Estimate £1,500,000
Current allocation received - study £195,000

This site has previously had a visual condition assessment completed by Board's officers. The inspection is currently the first part of an indicative allocation for funding towards developing a specification for refurbishment. Previous site inspections having been completed by consultant engineers Stantec who have been commissioned to develop a specification for 2 tender packages. The first to include all the Mechanical and Electrical elements, which will include the most significant change of pumps, as part of the requirement to enable compliance under current fish and eel regulations. A feasibility study will be completed to determine pump and pump motor replacement specification. The second will be the structural tender specification which will include recommendations of the report from structural inspections, which were completed at the beginning of April 2025.

- (ii) Cooks Lock PS Structural repairs study – Estimate £50,000

As part of a package of works, Stantec Engineering Consultants have been commissioned to complete structural inspections to the wet dry zone on the intake channel and also to the lower pump room, and suction channel. Following visual inspections previously completed by Board's officers, which identified evident oxidation to the structural steel. Stantec completed the structural survey at the beginning of April 2025. The Structural Engineers report when received will provide recommendations.

- (iii) Great Hale Fen PS Structural repairs - Estimate £970,000
Current allocation received – study £75,000

As reported at the Cooks Lock PS site, this site is also part of a package of works, Stantec Engineering Consultants have been commissioned to complete structural inspections to the wet dry zone on the intake channel and also to the lower pump room, and suction channel. Following visual inspections previously completed by Board's officers, which identified evident oxidation to the structural steel, and also some potentially structural concrete defects. Stantec completed part of the structural survey required at the beginning of April 2025 and will return to site to complete inspections of the pump chamber wet well areas when water levels have been reduced.

(iv) Swineshead Pumping Station replacement - £1,000,000

Current allocation received - study £500,000

As previously reported to the Northern Works Committee(NWC) meeting on 2nd July 2024.

Stantec Engineering Consultants completed a structural survey in March 2024 and the full report included in the 2024 NWC papers, providing the following conclusions and recommendations.

Conclusions

4.1 The steel sheet piled walls and pump support steelwork at the inlet have corroded to an extent that they have reached the end of their serviceable life. It is unlikely that any numerical structural assessment could demonstrate their stability or any acceptable factor of safety.

4.2 The poor condition of the pump support steelwork is a particular concern. The extent of corrosion is likely to have reduced the beam strength across the structure and could potentially fail.

5. Recommendations

5.1 The structure should be extensively repaired and reinforced (if feasible) or fully replaced.

Following this report and also included within the 2024 NWC a report initially presented to the Executive Committee meeting on 21st May 2024 outlined the proposed estimated costs and also a potential timeline for a programme of works.

However, due to there being no FCERM GiA indicative allocation in the current GiA programme, it has been agreed that due to the priority of this scheme over another that the Board has received funding, approval has been granted to reallocate these funds.

Therefore, currently Stantec are to continue, following a recent site visit, with the development of a Pump Feasibility Study to look at the best options for pumps considering the requirements of the pumping station in relation to operating regimes and electricity costs, to develop towards an outline design for the new pumping station.

Early contractor engagement will be necessary to further develop a budget estimate at the design stage, which will assist with anticipated costs and buildability. This information will help in the development of the Outline Business Case which is the scheme report as part of the approval process towards obtaining funding required.

(v) Holland Fen PS Structural Repairs – Estimate £970,000

Current allocation received – study £75,000

As part of a package of works, Stantec Engineering Consultants have been commissioned to complete structural inspections to the wet dry zone on the intake channel and also to the lower pump room, and suction channel.

Following visual inspections previously completed by Board's officers, which identified evident oxidation to the structural steel. Stantec completed the structural survey at the beginning of April 2025. The Structural Engineers report when received will provide recommendations.

(vi) Wyberton Marsh PS Structural Repairs – Estimate £970,000
Current allocation received – study £65,000

As part of a package of works, Stantec Engineering Consultants have been commissioned to complete structural inspections to the wet dry zone on the intake channel and also to the lower pump room, and suction channel. Following visual inspections previously completed by Board's officers, which identified evident oxidation to the structural steel. Stantec completed the structural survey at the beginning of April 2025. The Structural Engineers report when received will provide recommendations.

(vii) Black Sluice Catchment Strategy

This scheme has been commissioned, Stantec's brief is to provide:

A high-level model to give a strategic overview of the whole system which will provide the Board with priority areas to focus future studies and investments. The study will need to consider assessing the following areas:

- Pump efficiency – current vs alternative rules, this will enable a ranking of the pumps by the scale of the opportunity.
- Pump running costs
- Catchment combination/pumping station decommissioning
- Flood risk & future flood risk
- High level assessment of benefits available within the catchment

The Inception Study is currently being completed.

Currently the existing catchment is being modelled based upon a division into 12 catchments.

The total FCERM GiA currently applied for to complete this scheme is £250,000.

Future indicative Board contributions to facilitate the FCERM GiA funding have all now been removed from the schemes budget and potentially will be reprofiled into future years dependent upon the outcome of the Black Sluice Catchment Strategy.

2. 2025/26 Board funded capital schemes

(i) Jetting/CCTV survey of Major Pipelines – Estimate £40,000

A programme of works for the camera inspection and condition survey of pipelines within the catchments are to be completed in the Northern Works area.

(ii) Kirton Marsh PS replace MCC – Estimate £50,000

The Motor Control Centre(MCC) at this station installed in 1997 is to be replaced.

(iii) Kirton Marsh PS replace pump syphon valve – Estimate £5,000

The syphon valve at this pumping station requires replacement due to being faulty. The syphon breaker valve is a paddle operated butterfly valve designed to automatically control the priming and de-priming of the siphonic discharge. It is mounted on top of the discharge pipework. On pump start-up the valve allows air to discharge from the top of the siphon. When the pump stops the reverse flow acts on the paddle and opens the valve thereby destroying the vacuum in the pipe preventing continuing reverse flow through the pump.

(iv) Holland Fen PS 1 x pump motor refurbishment – Estimate £6,000

One of the electric pump motors at this pumping station now requires refurbishing.

(v) Great Hale Fen PS 1 x motor refurbishment – Estimate £5,000

One of the electric pump motors at this pumping station now requires refurbishing.

(vi) Cooks Lock PS refurbish weedscreen cleaner and controls

The weedscreen cleaner was installed in 2001 and now requires the trolley and control elements replacing.

(vii) Great Hale Fen PS replace MCC – Estimate £85,00

The Motor Control Centre(MCC) at this station installed in 1998 is to be replaced.

(viii) North Forty Foot(NFF) Desilting – Estimate £20,000

The NFF now requires desilting again downstream from Chapel Hill.

(ix) General culvert replacement contributions. – Estimate £5,000

Culverts that would be considered for benefit contribution from the Board, should access for maintenance be required, as per the terms of the Structures Replacement Policy.

3. 2026/27 Defra/EA FCERM GiA Schemes

(i) Cooks Lock PS new transformer – Estimate £55,000

This was proposed along with the programme of works to replace or remove the original HV electrical transformers, subject to alternative LV supply being applicable. It is now expected that the electrical supply to the site will form part of the scheme of refurbishment that is to be proposed along with the scheme of Structural Repairs.

4. 2026/27 Board funded capital schemes

(i) Claydyke Desilting – Estimate £130,000

It is proposed that the Claydyke from Holland Fen PS to the junction of the Gill a c4900km is desilted.

(ii) North Forty Foot Desilting – Estimate £60,000

It is proposed that the desilting works are continued started in 2025/26.

(iii) South Kyme Fen PS refurbish weedscreen cleaner & controls – Estimate £90,000

It is proposed that the weedscreen cleaner at this site which was installed in 2006 now requires the trolley and control elements replacing.

(iv) Jetting to Major Pipelines – Estimate £50,000

It is proposed to continue with the jetting and condition surveying of these pipelines.

(v) General culvert replacement contributions. – Estimate £5,000

Culverts that would be considered for benefit contribution from the Board, should access for maintenance be required, as per the terms of the Structures Replacement Policy.

5. IDB Recovery Fund Works

The following is a summary of where the Board are expected to be with the IDB Recovery Fund works at 31 March 2025.

Tranche 1	Application	Awarded	Reserve	Claimed	C/F to 2025/26
Helpringham Fen Pumping Station Pump Refurbishment	£ 219,709	£ 219,709		£ 184,709	£ 35,000
South Kyme Fen Pumping Station Pump Refurbishment	£ 289,709	£ 289,709		£ 249,709	£ 40,000
Ewerby Fen Pumping Station Pump Refurbishment	£ 419,709	£ 419,709		£ 314,709	£ 105,000
Dunsby Fen Pumping Station Pump Refurbishment	£ 204,709	£ 204,709		£ 144,709	£ 60,000
Dyke Fen Pumping Station AWC Refurbishment	£ 25,000	£ 25,000		£ 25,000	
Pinchbeck North Fen Pumping Station Pump Refurbishment	£ 164,000	£ 164,000		£ 160,000	£ 4,000
Donington Northorpe Culvert Repair	£ 155,000	£ 155,000		£ 125,000	£ 30,000
Electricity Costs	£ 452,936	£ 452,936		£ 452,936	
Catchment Wide Bank Slips	£ 1,060,830	£ 855,220		£ 855,220	
Donington North Ings Access track	£ 185,430	£ 185,430		£ 185,430	
	£ 3,177,032	£ 2,971,422	£ -	£ 2,697,422	£ 274,000

Tranche 2	Application	Awarded	Reserve	Claimed	C/F to 2025/26
Great Hale Pumping Station Refurbishment	£ 30,000	£ 30,000		£ 17,000	
Installation Level Controllers Pumping Station	£ 80,000	£ 80,000		£ 80,000	
Mobile Pumps	£ 250,000	£ 265,000		£ 265,000	
Damford Grounds Pumping Station Refurbishment	£ 155,000	£ 155,000		£ 151,000	
	£ 515,000	£ 530,000	£ -	£ 513,000	£ -

Tranche 2b	Application	Awarded	Reserve 30/04/2025	Claimed	C/F to 2025/26
Dunsby AWC	£ 247,000	£ -			
Embankments Projects	£ 3,356,219	£ -	£ 3,000,000		£ 3,000,000
Kyme Eau Embankment AT Damford	£ 105,346	£ 105,346			£ 105,346
Gosberton PS Improvements	£ 1,168,700	£ -			
	£ 4,877,265	£ 105,346	£ 3,000,000	£ -	£ 3,105,346
	£ 8,569,297	£ 3,606,768	£ 3,000,000	£ 3,210,422	£ 3,379,346

6. Emergency Response Plan

A reminder regarding the Emergency Response Plan and a fluvial event; The South Forty Foot banks are seen to be at risk of breaching when the water levels rise above 2.70m ODN at Black Hole Drove pumping station. If this occurs the pumps at the Boards pumping stations shall start to be switched off by remote telemetry control as agreed by the Emergency Response Team at the same time switching all pumps to their Emergency Profile Level as identified within the Emergency Response Plan. The pumps shall remain switched off until the level of the water in the South Forty Foot Drain at Black Hole Drove reduces to 2.30m ODN.

Should the event become more extreme then a decision will need to be made by the Emergency Response Team in conjunction with the Chairperson of the Board on whether water levels in the Fens should be allowed to rise higher than the figures shown within the Emergency Response Plan, live CCTV footage showing the pumping station suction bays will be assessed when making these decisions.

7. Crop Loss

A reminder regarding grass, hay, silage fields as stated within the Boards Crop Loss Compensation Policy (No.46). During Summer Cutting, compensation will not be paid for access by machinery through grassland, hay or silage fields. Other maintenance works, i.e. de-silting and bushing works compensation will be paid for damage to grass, hay or silage fields at £1,310.00/hectare, all as per policy 46, details of which can be found on the Board's website.

**Black Sluice Internal Drainage Board
10 Year Schemes Budget 2025/26 - 2034/35**

Year	Type	Scheme	Total	Grant / Local Levy	Other Contributions	Possible Board Contribution	Drain	PS	
2025/26	Drain	SFFD Desilting Guthrum to Blackhole Drove PS	£105,000				£105,000		
	Drain	Black Hole Drove p/s under pump inspections	£35,000				£35,000		
	Pump	Kirton Marsh PS replace MCC	£80,000					£80,000	
	Pump	Kirton Marsh PS replace syphon valve	£5,000					£5,000	
	Pump	Horbling Fen PS 1 x pump motor refurbishment	£4,000					£4,000	
	Pump	Holland Fen PS 1 x Motor refurbishment	£6,000					£6,000	
	Pump	Great Hale Fen PS 1 x Motor Refurbishment	£5,000					£5,000	
	Pump	Cooks Lock PS refurbish weedscreen cleaner & controls	£95,000					£95,000	
	Pump	Great Hale PS Fen replace MCC	£85,000					£85,000	
	Drain	Jetting to major pipelines	£40,000				£40,000		
	Drain	NFF Desilting	£20,000				£20,000		
	Pump	Head Dyke bank repairs(South Kyme PS) works	£1,808,228	£1,808,228					
	Pump	Hodge Dyke bank repairs(Ewerby Fen PS) works	£2,034,251	£2,034,251					
	Pump	Trinity College Bank Repair Works	£3,089,048	£3,089,048					
	Pump	Damford PS Bank Repair Works	£602,740	£602,740					
	Pump	Black Hole Drove PS - Structural Repairs	£50,000	£50,000					
	Pump	Chain Bridge PS - Structural Repairs	£1,500,000	£1,500,000					
	Pump	Cooks Lock PS - Structural Repairs	£50,000	£50,000					
	Pump	Donington NI PS - Structural Repairs	£450,000	£450,000					
	Pump	Swineshead PS Replacement	£1,000,000	£1,000,000					
	Pump	Great Hale PS - Structural Repairs	£1,290,000	£1,290,000					
	Pump	Holland Fen PS - Structural Repairs	£970,000	£970,000					
	Pump	Horbling Fen PS - Structural Repairs	£50,000	£50,000					
	Pump	Wyberton Marsh PS - Structural Repairs	£970,000	£970,000					
	Drain	General culvert replacement contributions	£5,000				£5,000		
				£14,349,267	£13,864,267			£205,000	£280,000
	2026/27	Drain	Claydyke desilting	£130,000				£130,000	
Drain		NFF Desilting	£60,000				£60,000		
Drain		Jetting to major pipelines	£50,000				£50,000		
Pump		Helpringham Fen PS new roof	£18,500					£18,500	
Pump		Gosberton Fen PS Refurbish 3 x axial flow pumps	£78,750					£78,750	
Pump		Dowsby Fen PS replace MCC	£60,000					£60,000	
Pump		South Kyme Fen PS refurbish w/s cleaner & controls	£90,000					£90,000	
Pump		Swaton Fen PS replace MCC	£48,000					£48,000	
Pump		Rippingale Fen PS replace MCC	£48,000					£48,000	
Pump		Donington North Ings PS new transformer	£55,000	£55,000					
Pump		Cooks Lock PS new transformer	£55,000	£55,000					
Pump		Holland Fen PS under pump inspections	£28,000					£28,000	
Pump		Donington NI PS - Structural Repairs	£450,000	£450,000					
Drain		Graft Drain	£45,000				£45,000		
Drain		General culvert replacement contributions	£5,000				£5,000		
			£1,221,250	£560,000			£290,000	£371,250	
2027/28	Drain	Graft Drain	£95,000				£95,000		
	Drain	Jetting to major pipelines	£75,000				£75,000		
	Pump	Holland Fen PS replace MCC	£90,000					£90,000	
	Drain	New Hammond Beck Desilting	£75,000				£75,000		
	Drain	Dowsby Fen Catchment Works	£350,000	£162,686	£137,314	£50,000			
	Pump	Kiron Marsh PS new roof	£23,000					£23,000	
	Pump	Bicker Fen refurbish 1 x axial flow pump	£33,000					£33,000	
	Pump	Bicker Fen PS replace weedscreen cleaner	£155,000					£155,000	
	Pump	Wyberton Chain Bridge PS new transformer	£60,000	£60,000					
	Pump	Holland Fen PS new transformer	£75,000	£75,000					
	Pump	Donington Northings PS refurbish 3 x axial flow pumps	£85,000					£85,000	
	Pump	Ewerby Fen PS refurbish 2 x axial flow pumps	£58,000					£58,000	
	Drain	General culvert replacement contributions	£5,000				£5,000		
			£1,179,000	£297,686	£137,314	£50,000	£250,000	£444,000	
2028/29	Drain	Old Hammond Beck Desilting	£80,000				£80,000		
	Drain	Jetting to major pipelines	£80,000				£80,000		
	Pump	Twenty PS refurbish 1 x axial flow pump & motor	£35,000					£35,000	
	Drain	Bourne Fen 28/10 Revetment	£30,000				£30,000		
	Pump	Helpringham PS new roof	£20,000					£20,000	
	Pump	Wyberton Chain Bridge PS under pump inspection	£25,000					£25,000	
	Pump	Wyberton Chain Bridge PS refurbish 3 x axial flow pumps	£90,000					£90,000	
	Pump	Wyberton Chain Bridge PS replace MCC	£72,000					£72,000	
	Pump	Dowsby Fen PS refurbish 2 x axial flow pumps	£58,000					£58,000	
	Pump	Swaton Fen PS replace weedscreen cleaner	£160,000					£160,000	
Drain	General culvert replacement contributions	£5,000				£5,000			
			£655,000				£195,000	£460,000	
2029/30	Drain	Jetting to major pipelines	£80,000				£80,000		
	Pump	Great Hale Fen PS refurbish 3 x axial flow pumps	£95,000					£95,000	
	Drain	Cooks lock PS pump drain desilting under pump inspection	£56,000				£56,000		
	Pump	Quadring Fen PS replace MCC	£40,000					£40,000	
	Pump	Mallard HumPS under pump inspections	£32,000					£32,000	
	Pump	Damford Grounds PS under pump inspections	£32,000					£32,000	
	Pump	Helpringham Fen PS under pump inspections	£32,000					£32,000	
	Pump	Swaton Fen PS under pump inspections	£32,000					£32,000	
	Pump	Billingham Fen PS under pump inspections	£32,000					£32,000	
	Pump	Pinchbeck Fen PS under pump inspections	£32,000					£32,000	
	Pump	Haconby Fen PS refurbish 1 x axial flow pump	£30,000					£30,000	
	Pump	Gosberton Fen PS replace MCC	£80,000					£80,000	
	Drain	Quadring Fen pump drain desilting/under pump inspection	£48,000				£48,000		
	Drain	General culvert replacement contributions	£5,000				£5,000		
			£626,000				£189,000	£437,000	

2030/31	Drain	Damford PS pump drain desilting/under pump inspections	£50,000			£50,000	
	Drain	Jetting to major pipelines	£60,000			£60,000	
	Pump	Horbling Fen PS replace MCC	£45,000				£45,000
	Pump	Mallard Hum PS replace MCC	£45,000				£45,000
	Pump	Mallard Hum PS under pump inspections	£10,000				£10,000
	Pump	Trinity College PS refurbish 2 x axial flow pumps	£63,000				£63,000
	Pump	Ewerby Fen PS under pump inspections	£34,000				£34,000
	Pump	South Kyme Fen PS under pump inspections	£34,000				£34,000
	Pump	Sempringham Fen PS under pump inspections	£34,000				£34,000
	Pump	Black Hole Drove PS refurbish 3 x axial flow pumps	£100,000				£100,000
	Pump	Great Hale Fen PS replace MCC	£90,000				£90,000
	Pump	Kirton Marsh PS replace MCC	£50,000				£50,000
	Drain	General culvert replacement contributions	£5,000			£5,000	
				£620,000			£115,000
2031/32	Drain	Jetting to major pipelines	£90,000			£90,000	
	Drain	Heckington Fen pump drain desilting under pump inspections	£50,000			£50,000	
	Pump	Billingborough Fen p/s replace MCC	£50,000				£50,000
	Pump	Dowsby Lode PS replace MCC	£50,000				£50,000
	Pump	Pinchbeck Fen PS replace MCC	£50,000				£50,000
	Pump	Cooks Lock PS refurbish 3 x axial flow pumps	£105,000				£105,000
	Pump	Swaton Fen PS refurbish 1 x axial flow pump	£35,000				£35,000
	Pump	Twenty PS replace MCC	£55,000				£55,000
	Drain	Dowsby Fen PS drain desilting under pump inspections	£49,000			£49,000	
	Drain	Dowsby Lode PS under pump inspections	£36,000			£36,000	
	Drain	Dunsby Fen PS under pump inspections	£36,000			£36,000	
Drain	General culvert replacement contributions	£6,000			£6,000		
			£612,000			£267,000	£345,000
2032/33	Drain	Jetting to major pipelines	£70,000			£70,000	
	Pump	Rippingale p/s refurb 1 x axial flow pump	£37,000				£37,000
	Drain	Gosberton Fen pump drain desilting/under pump inspections	£56,000			£56,000	
	Drain	Donington Northings PS desilting under pump inspections	£56,000			£56,000	
	Drain	Great Hale Fen PS desilting under pump inspections	£56,000			£56,000	
	Drain	Trinity College PS desilting under pump inspections	£56,000			£56,000	
	Pump	Holland Fen PS refurbish 3 x axial flow pumps & motors	£118,000				£118,000
	Pump	Helpringham Fen PS refurbish 1 x axial flow pump	£38,000				£38,000
	Drain	General culvert replacement contributions	£7,000			£7,000	
			£494,000			£301,000	£193,000
2033/34	Drain	Great Hale Fen PS desilting/under pump inspections	£55,000			£55,000	
	Drain	Trinity College PS desilting/under pump inspections	£40,000			£40,000	
	Drain	Horbling Fen PS desilting/under pump inspections	£35,000			£35,000	
	Drain	Bicker Fen PS desilting/under pump inspections	£40,000			£40,000	
	Drain	Jetting to major pipelines	£70,000			£70,000	
	Pump	Kirton Marsh PS refurbish weedscreen cleaner & controls	£110,000				£110,000
	Pump	Swaton Fen PS refurbish 1 x axial flow pump & motor	£45,000				£45,000
	Pump	Sempringham Fen PS refurb pump & motor	£45,000				£45,000
	Pump	Horbling Fen PS refurbish weedscreen cleaner & controls	£90,000				£90,000
	Drain	NFF desilting	£60,000				£60,000
Drain	General culvert replacement contributions	£7,000			£7,000		
			£597,000			£247,000	£350,000
2034/35	Pump	Kirton Marsh PS desilting & under pump inspections	£90,000			£90,000	
	Pump	Rippingale Fen PS desilting & under pump inspections	£90,000			£90,000	
	Pump	Haconby Fen PS desilting & under pump inspections	£90,000			£90,000	
	Drain	NFF desilting	£100,000			£100,000	
	Pump	Dowsby Lode PS refurbish 1 x axial flow pump & motor	£75,000				£75,000
	Pump	Blackhole Drove PS refurbish weedscreen cleaner & controls	£110,000				£110,000
Pump	Horbling Fen PS refurbish 1 x axial flow pump & motor	£75,000				£75,000	
Drain	General culvert replacement contributions	£7,000				£7,000	
			£637,000			£370,000	£267,000

BLACK SLUICE INTERNAL DRAINAGE BOARD Rainfall at Swineshead Depot

MONTH	Rainfall		Actual / Average
	Actual	25 Year Average	
	mm	mm	%
May-24	68.6	53.5	128.22%
Jun-24	30.8	53.6	57.46%
Jul-24	88.0	65.6	134.15%
Aug-24	35.8	65.0	55.08%
Sep-24	109.0	45.2	241.15%
Oct-24	54.6	64.3	84.91%
Nov-24	49.0	50.4	97.22%
Dec-24	58.8	49.8	118.07%
Jan-25	64.0	45.2	141.59%
Feb-25	18.0	37.7	47.75%
Mar-25	7.2	34.3	20.99%
Apr-25	32.0	36.4	87.91%
Totals	615.8	601.0	102.46%

